

IMPERIAL TIE-BOMBER

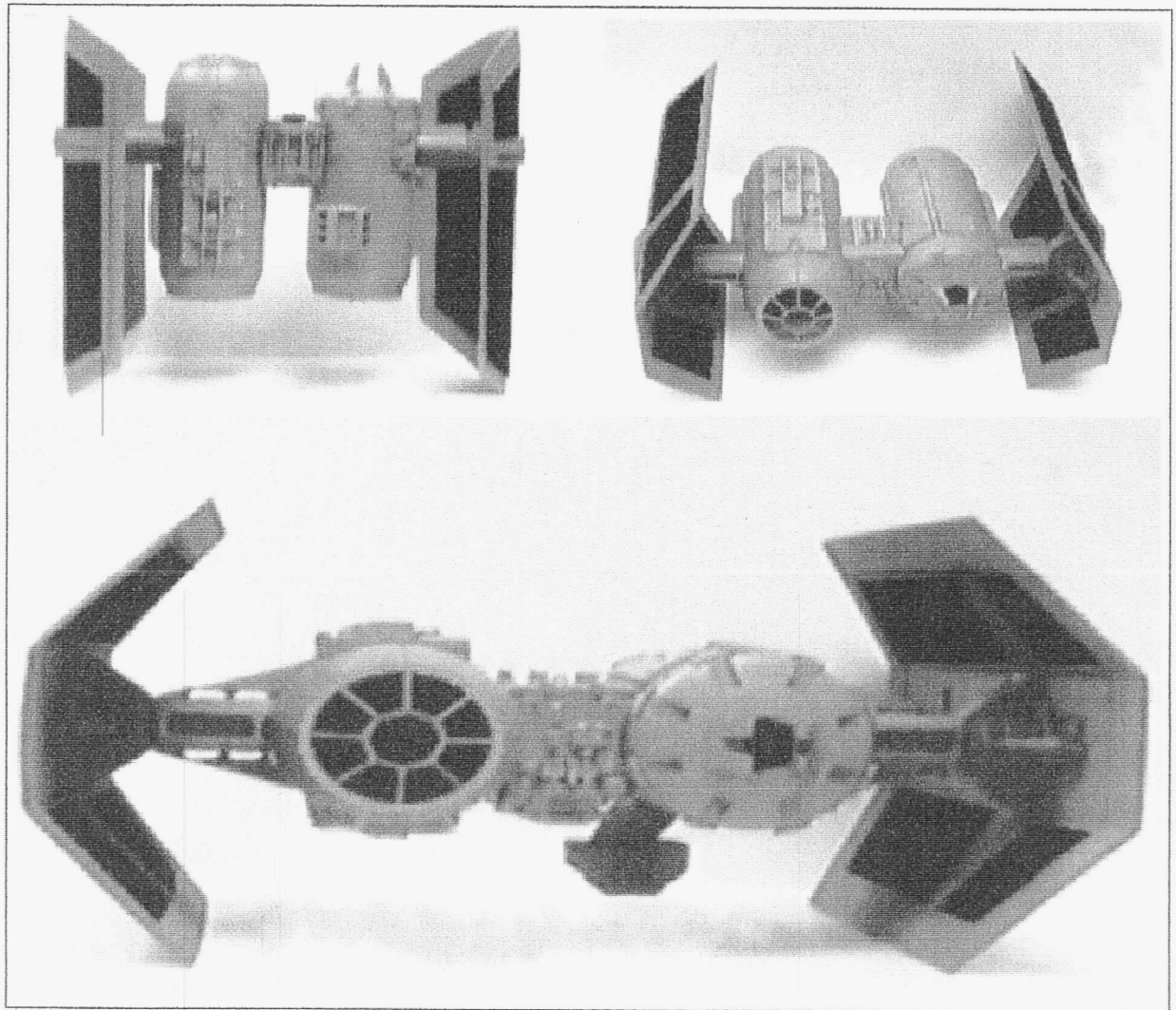

Imperial Docket:0001

Before you begin to assemble your model kit, study the instructions carefully. This will help to familiarize you with the location and parts required for assembly. If you wish to paint your model, various components should be painted before the parts are attached. The appropriate color is stated in the paint guide at the end of the instructions sheets. This kit is molded from a plastic resin. Use of a superglue that is formulated for resin is recommended.

For the best finish your model should be painted, even if molded in color. Paint should be applied in several light coats rather than one heavy one (the first coat should not completely cover the surface). Each layer should dry thoroughly before sanding with #1200 grit wet or dry sandpaper that is slightly damp, except for the final coat. ****BE CAREFUL NOT TO REMOVE ANY DETAIL WHILE SANDING****.

Keep your hands clean when working with the model prior to painting. Always **thoroughly wash parts to remove any mold release agent**, body oils from your hands and sanding residue. A solution of dish washer detergent and water is recommended. Use a tack cloth to dry as paper towel leaves lint on the surface.

Parting lines and glue joints should be filled and sanded before painting. A filler putty designed for use on plastics should be used to blend and fill contours. This should be applied only after the first 'primer' coat of paint is applied.

When painting a body of two or more colors, the lightest color should be painted first. Use frosted or liquid masking agent to protect areas you do not want painted. After the paint is dry to the touch you may remove the masking agent. Use a very fine brush to touch up any edges that may require it. If decals are added do so before applying the gloss coat (a gloss or matt clear coat will help even out the edges between the colors, decals and help to prevent unwanted finger prints from marring the finish.

Prior to cementing any parts together, be sure to 'TEST FIT' them in order to assure alignment. Also check for excess 'flash' that may be present, use a sharp hobby knife or file if necessary.

Warranty: Because we have no control over the working conditions, skills or methods, our liability is limited to the price of this product.

We take pride in providing kits which give attention to detail and workmanship. Should you have difficulty with missing parts or assembly please e-mail the address below

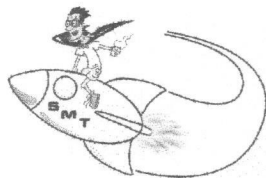

sntemail@telusplanet.net

TIE BOMBER

Please check your kit to ensure you have the following parts.

Parts listing for 1:48 scale Tie Bomber

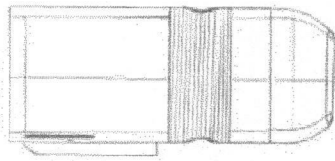

A

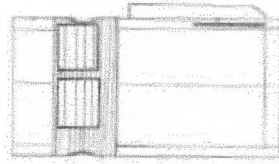

B

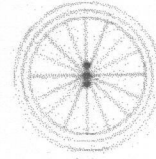

F x2



Rear



C1

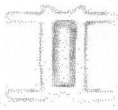

D

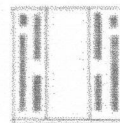

E

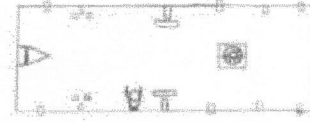

G x2

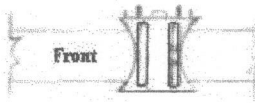

Front

C



H x2



I x4



J x4



K

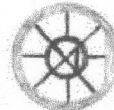

L



M

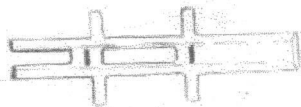

N x2

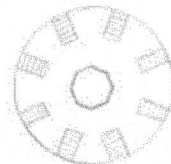

O

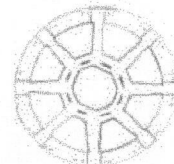

P



X

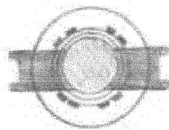

Q x2

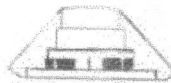

R x4



T x4

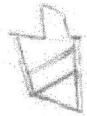

U

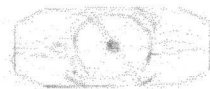

V x2

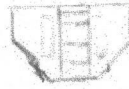

W



Y x2

TIE BOMBER

Step#1

Locate the main body pylon support labeled part 'C'. You will also need parts 'C-1' and 'E'. Part 'E' should be glued to the bottom of part 'C' and even with the rear of part 'C'. This should create a shallow ridge at the front between 'C' and 'E'. Sand and fill any unwanted imperfections. Part 'C-1' should be attached to part 'C' being level at the top and cemented in the front on the two vertical runners. Attach parts 'X' to the front of part 'E'.

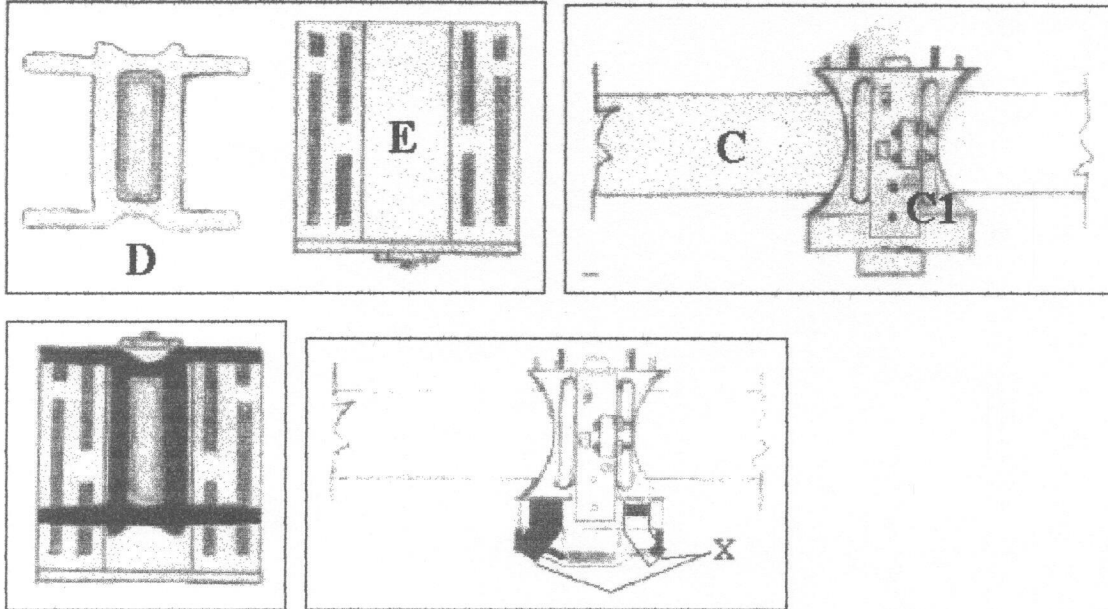

Step#2

Locate part 'B'. Attach part 'F' to the rear of the body paying attention to the orientation. The grooves should line up with the panel lines on the body and the three spikes on part 'F' should run east to west (not north and south). The two 5/8" holes on the side of the body should be drilled out to slide easily over the the 5/8" tube of part 'C'.

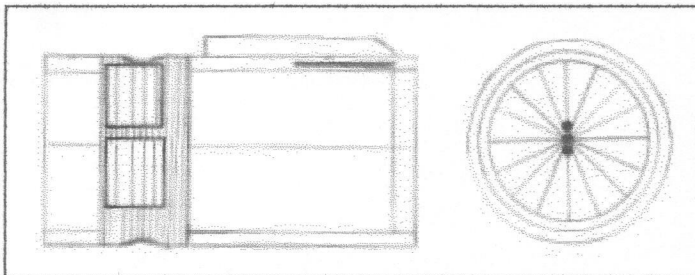

Attach part 'O' to the front of the bomber body with the orientation of the corners lining up with the panel lines on the body.

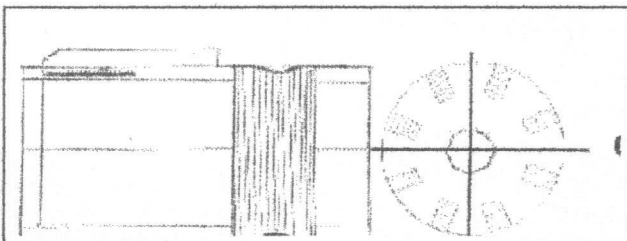

TIE BOMBER

There should be 8 (eight) of part 'S'. One each lines up with the grooved details on the front of part 'O'. These may need to be sanded in both directions to ensure a tight fit (use a 2" outside diameter pipe with a piece of sandpaper on it).

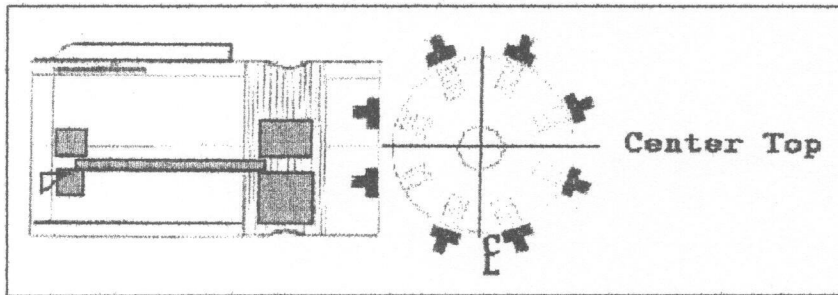

Attach part 'H' (2x) to the face of the bomb bay, they should be vertical on the body.

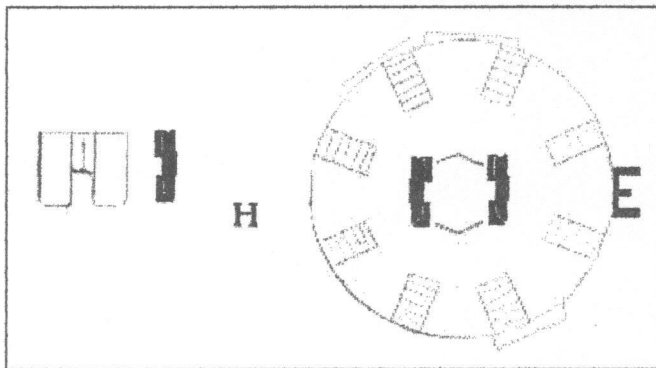

Drill out a 1/4" hole in part 'B' on the bottom at the center of the small square panel for attaching the sensor pod at a later step.

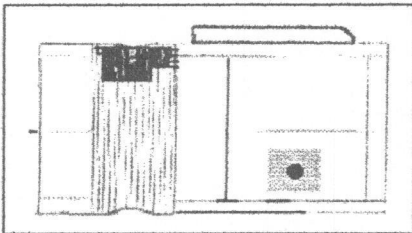

Once you are satisfied with the alignment and fit of parts slide the completed part 'B' onto the right side of the center pylon (facing front).

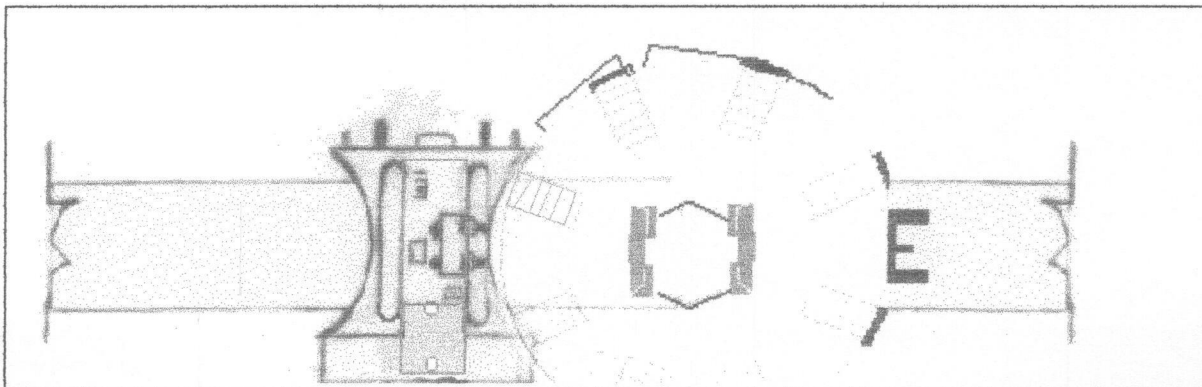

TIE BOMBER

Step#3

Locate part 'A' main body. Locate parts 'G' (2x). You also need parts 'N'. Glue part 'N' to the top of 'G' first test fitting and trimming 'N' to length. This should be done for both the top and bottom of part 'A'.

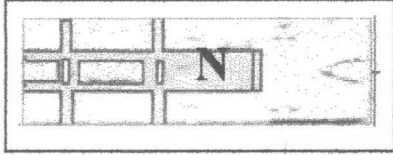

Glue parts 'G' to part 'A' centering 'G' on 'A' between the panel lines ('L' is omitted for clarity).

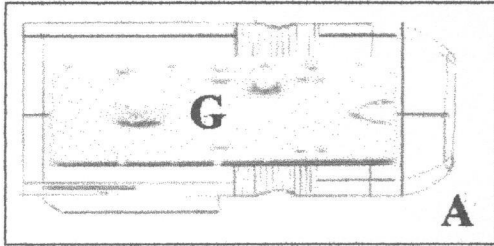

Step#4

Locate the interior parts 'K' 'L' and 'M'. Clean, fill and paint. Let dry before assembling. To assemble locate part 'L' and 'K'. Glue 'L' to 'K' noticing the orientation of 'L' and locating it to the center notch in 'K'. Part 'M' attaches to 'K' by a similar notch at the top of the "arms" in 'M'. Be certain the completed interior looks as per drawing. The side grooves in 'K' are needed to the rear to fit the support pylon. Highlight the interior as desired. The back wall should be painted dark grey with floor and front painted flat black. Pick out details on the front with silver highlights for best effect.

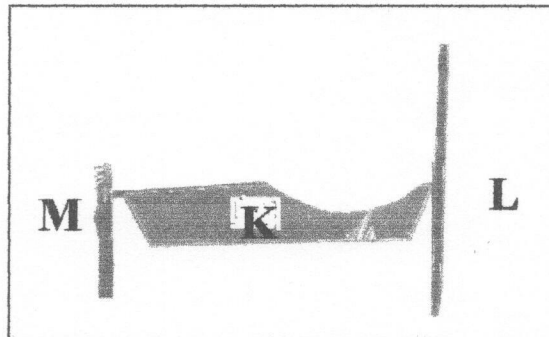
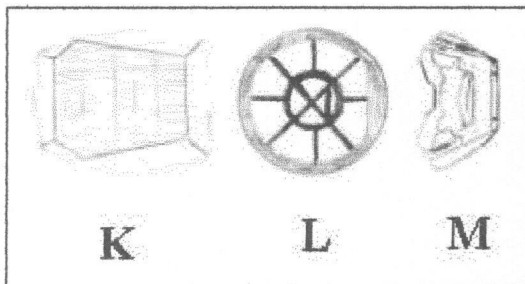

Step#5

When dry the completed assembly may be inserted into part 'A' (DO NOT GLUE) sliding it all the way forward until the side grooves in 'J' line up with support pylon holes in part 'A'. TEST FIT TO BE SURE. When satisfied with the alignment cement in place.

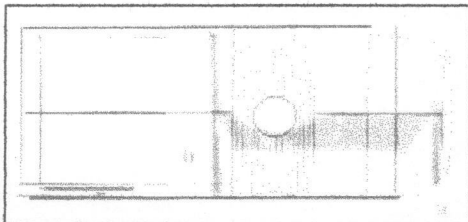

TIE BOMBER

Step#6

Locate part 'P'. Test fit window to part 'A' as best alignment can be achieved.

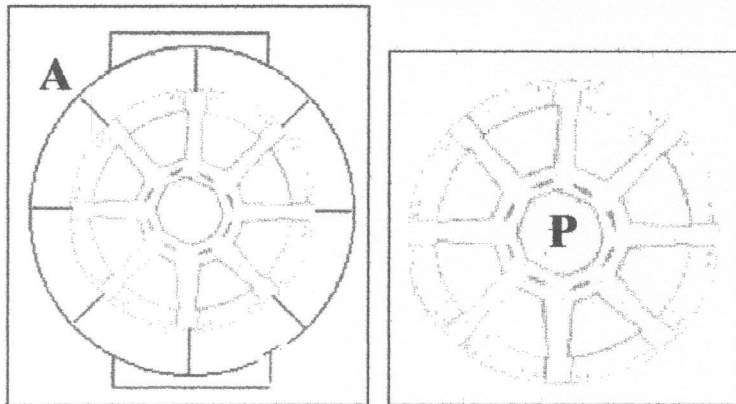

Locate part 'A'. Attach part 'F' to the rear of the body, paying attention to the orientation. The grooving should run at compass points to the body and line up with panel lines. Sand and fill any unwanted seams on both ends.

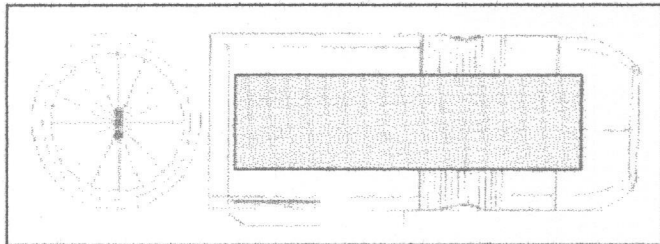

Locate part 'T'. There are two (2) per side. There are two lines outlining a slot in 'T'. Cut these out to provide for the placement of the fins.

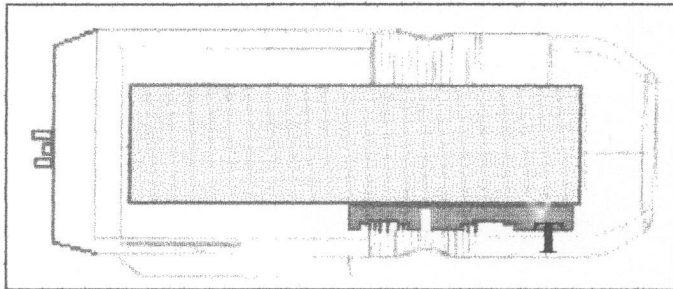

Step#7

Once you are satisfied with the fit of the parts slide completed part 'A' onto the left side of the center pylon (facing front). Gently slide part 'A' over part 'C', paying attention to the orientation. Fill and sand the join to the center pylon.

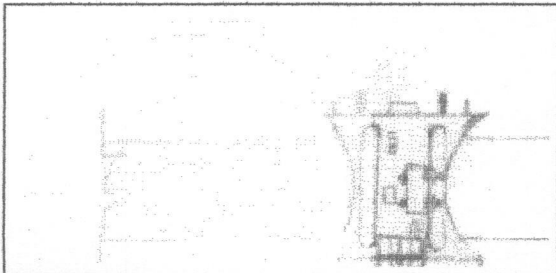

TIE BOMBER

Step#8

Next locate part 'I' (4x). These are located on the top and bottom of the center support pylon. The fins should be centered on the tube. The fins may have to be heated slightly (using hot/warm water or a hair dryer on low) and bent to best fit.

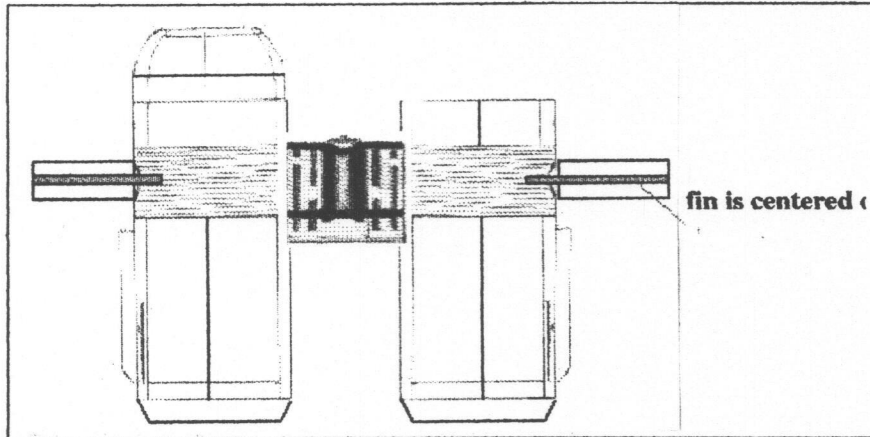
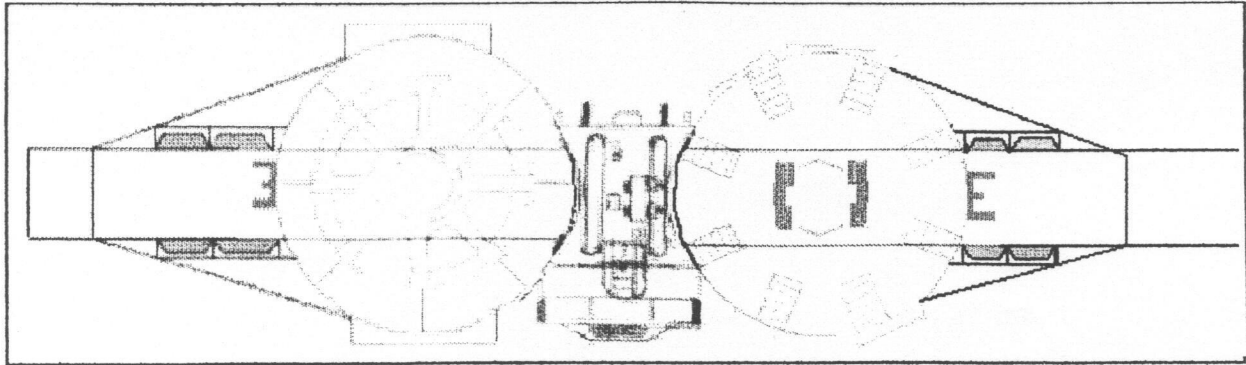

TIE BOMBER

Step#9

Next locate part 'J' (4x). These are attached to the front and rear of the tube and centered in an opposite alignment to the fins.

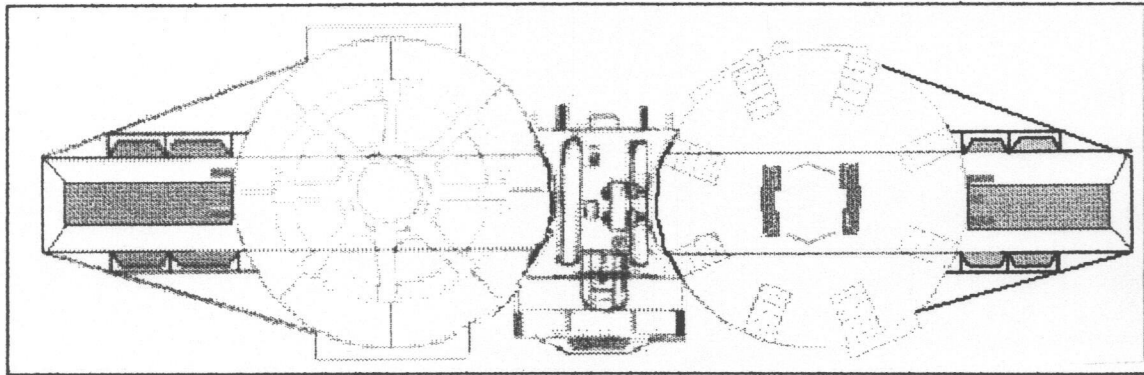
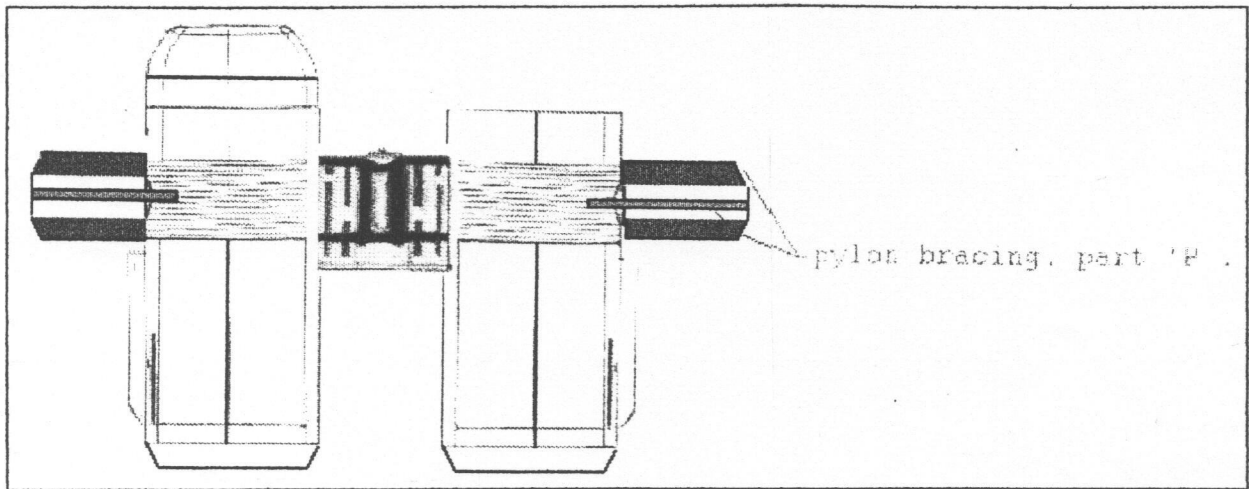

TIE BOMBER

Step#10

You now need the two wings from the AMT/ERTL Vader kit. You will need plastic sheet styrene. This should be cut 1.5cm wide and follow the wing angles around. This strip should butt up tight to the raised edge of the grill work on the **INSIDE** of the wing. Once in place follow the drawing below to aid in fine detailing. Locate parts 'Y'. These replace the inner panels from the Vader kit.

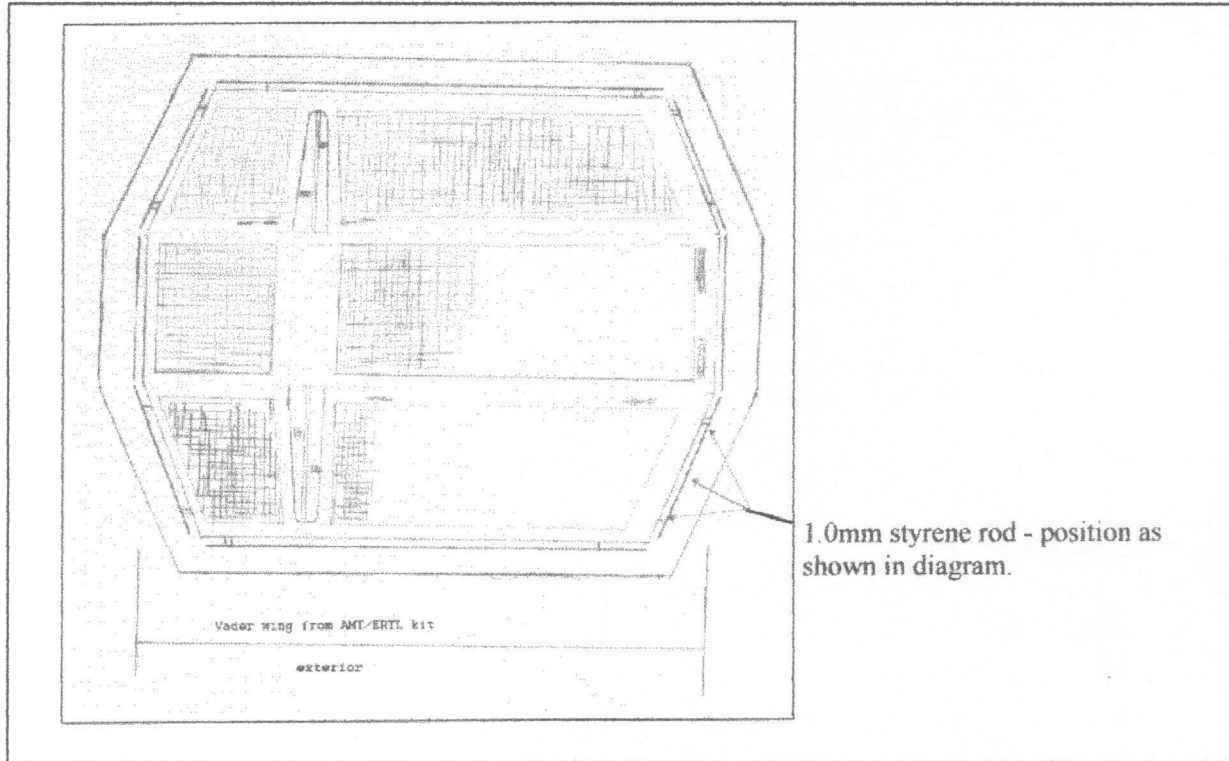

Locate parts 'Q' (2x) wing root attachment and parts 'Y'. Test fit parts to the wings, they should fit snugly. When satisfied with fit cement in place and fill any unwanted imperfections.

Locate parts 'R' (4x). You need two per wing. They attach to the second tier on the root of the wing and to the small depression in the wing inner panel just ahead and behind the attachment.

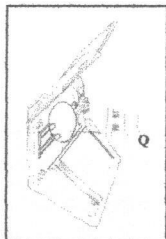
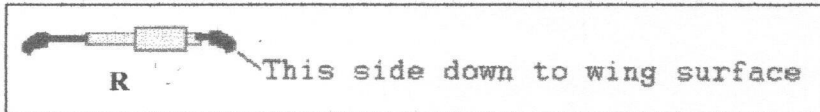

TIE BOMBER

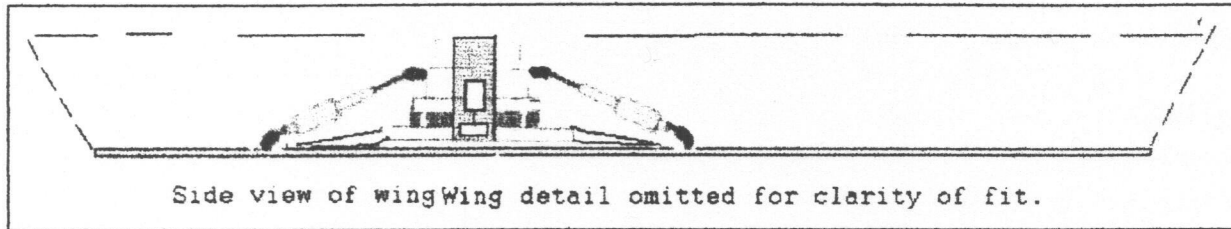
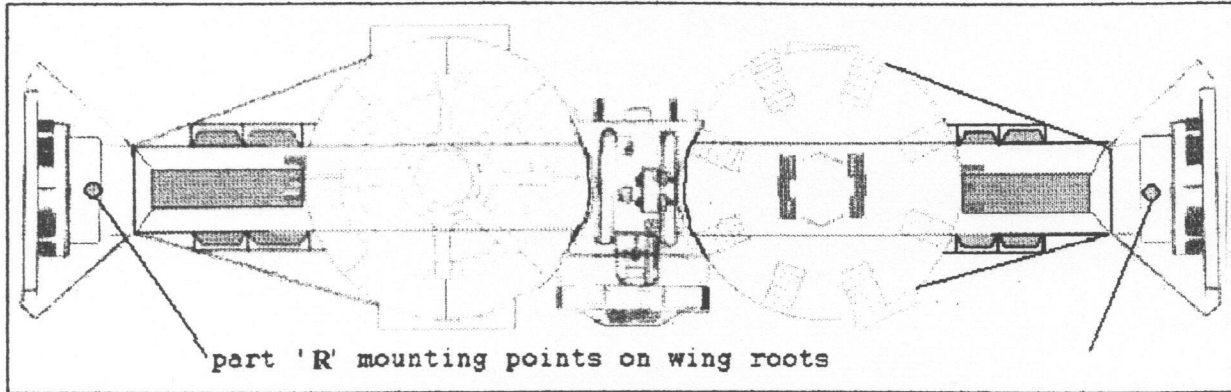

Part 'V' should be cemented to the outside wing surface in direct alignment with wing root.

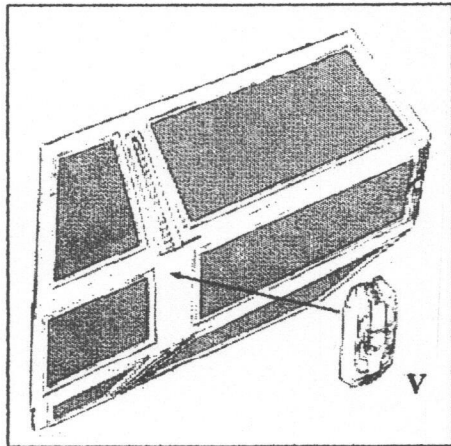

TIE BOMBER

Step#12

The wings should fit snugly to the center pylon. The smaller pipe may be cut to fit as necessary. If you wish the wings may be left loose to aid in removal if desired (wings omitted for clarity).

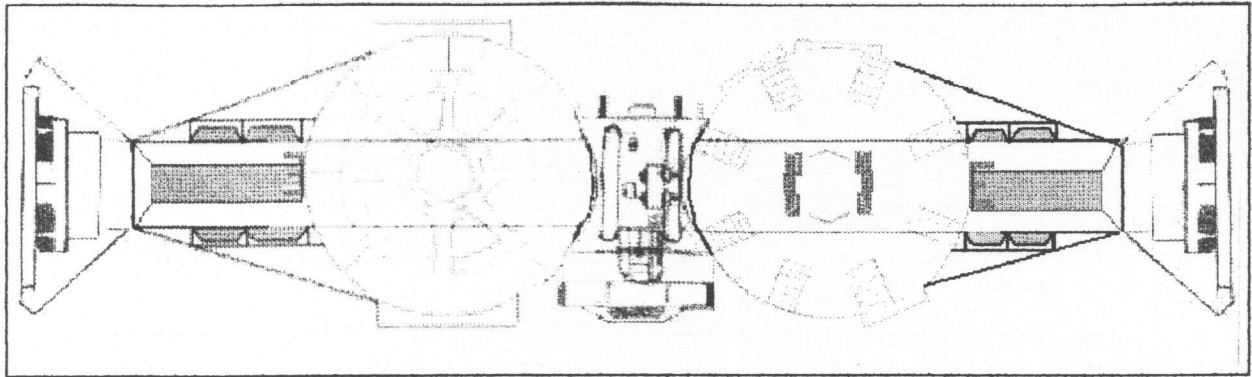

Step#13

Locate 'U' and 'W' for the sensor array. Cement 'U' on top of 'V' paying attention to the diagram below (part 'U' should be centered on top of 'V'). The completed part should then be cemented in place on the bomber body (part 'B') as drilled out earlier.

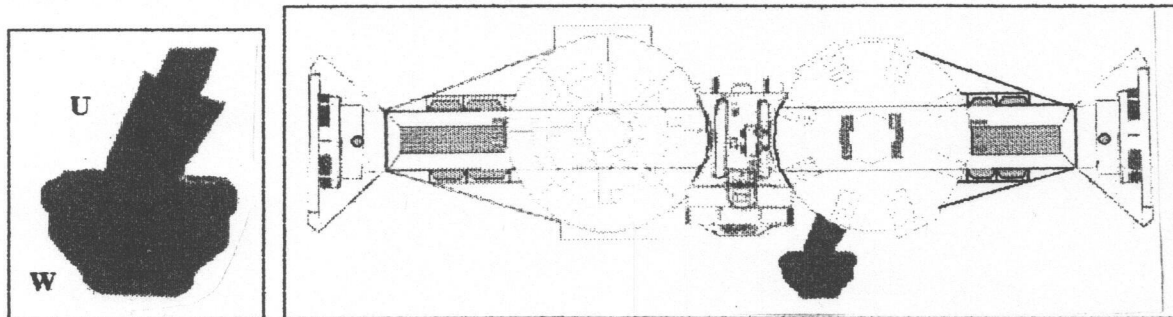

TIE BOMBER 1:48 SCALE

ADDENDUM:

Although we pride ourselves on producing an accurate scale model of your favorite subjects, mistakes omissions and simply lack of available material may mean we have "missed" a detail or two (or gotten it wrong). The following are things we DID NOT include with this kit or left out of the molding process to allow quality castings.

- 1) Small fin detail along the interior of each wing at the place where the flat middle bends out to the sides. This appears to be Tamiya or similiar 1:35 Flakvierling track links.
- 2) The original studio model contains no interior so feel free to detail this one with a pilot etc, following styles already laid out by Ertl/Amt Vader kit and the twin Tie fighter pack.
- 3) A more complete interior and bombbay interior may be offered at a later date.
- 4) Small fins should be located on the long flat straight edges of part 'S' (4x) and at the front of part 'I' (4x)
- 5) All of the pieces that represent girder work (part 'D', part 'I') should have hollowed out ends
- 6) A display base
- 7) The join between the bomb front and engine rings should be slightly visible to create a non-can look
- 8) Hope the following will clear up any questions you may have in regard to placement.

