

## 1/48<sup>scale</sup> Tie Obliterator

Model Kit by SMT: <http://smt.theshoppe.com>

Pattern Maker: Alfred Wong, website: <http://members.rogers.com/alterego>  
Ship Concept & Design: Alfred Wong

Type: Two seat Starfighter  
Operators: Imperial  
Armament: 1 Superlaser

The Tie Obliterator was developed as an attempt to counter New Republic capital-ships with a relatively inexpensive, fighter sized craft. The entire fuselage of the craft is occupied by a powerful superlaser with its integral power cell. The cockpit pod, taken from a standard Tie-bomber is perched above with accommodation for a crew of 2; the pilot and navigator/gunner. The aft end of the pod no longer houses the engines, and is replaced by an airlock and entry hatch for the crew. The 2 twin-ion engine pods are now located at the tips of the large solar array wings, between the paired panels. The very small number of Tie Obliterators produced achieved some early successes. However as their deployment became known they became priority targets for New Republic ships. Of the 20 ever produced all were either destroyed or captured by New Republic forces.

# 1:48 Scale Tie Obliterator

Before you begin to assemble your model kit, study the instructions carefully. This will help familiarize you with the location and parts required for assembly. If you wish to paint your model, various components should be painted before the parts are attached. The appropriate color is stated in the paint guide at the end of the instructions. This kit is molded from a plastic resin. Use of a superglue is required for assembly.

For the best finish your model should be painted even if molded in color. Paint should be applied in several light coats rather than one heavy one (the first coat should not completely cover the surface). Each layer should dry thoroughly before sanding with #1200 wet or dry sandpaper that is slightly damp, except for the final coat.

**\*\* Be careful not to remove any detail while sanding \*\***

Keep your hands clean when working with the model prior to painting. Always thoroughly wash parts to remove any trace of mold release agents, body oils from your hands and sanding residue. A solution of dish washer detergent and water is recommended. Use a tack cloth to dry.

Parting lines and glue joints should be filled and sanded before painting. A filler putty designed for use on plastics should be used to blend and fill contours. This should be applied only after the first primer coat.

When painting a body of two or more colors, the lighter color should be painted first. Use frosted or liquid masking agent to protect any areas you do not want painted. After the paint is dry to the touch you may remove the masking agent. Use a very fine brush to touch up any edges that may require it. If decals are added do so before applying the gloss coat (a gloss or matted coat will help even the edges between the colors, decals and help to prevent unwanted fingerprints from marring the finish).

Prior to cementing any parts together "test fit" them in order to be assure alignment. Also check for excess flash which may be present, use a sharp hobby knife or file if necessary.

If any parts are warped, apply a small amount of heat (such as a hair dryer or hot water) until you feel the resin soften. Gently bend back to shape.

We take pride in providing kits which are easy to assemble and give attention to detail and workmanship. Should you have any difficulty with missing/broken pieces or assembly please e-mail the address below:

**SMTEMAIL@telusplanet.net**

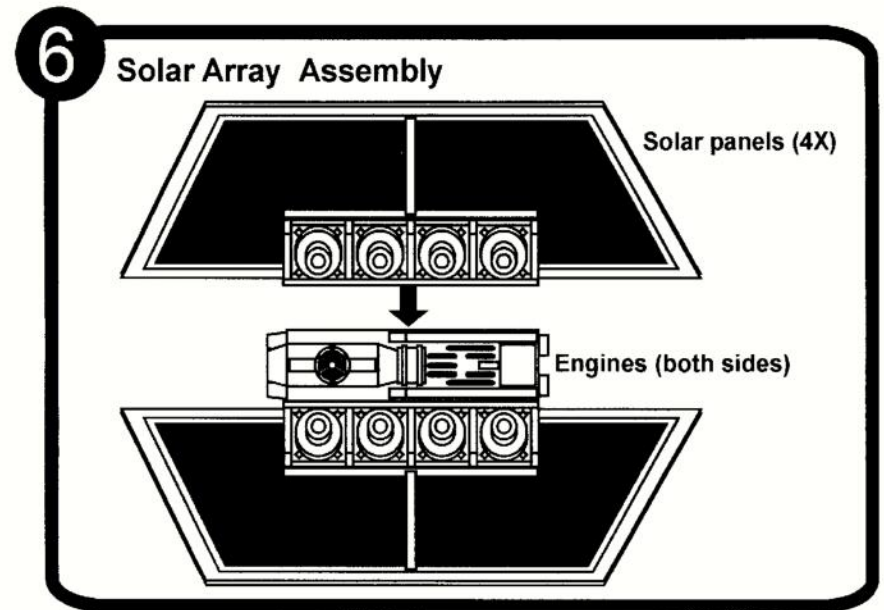
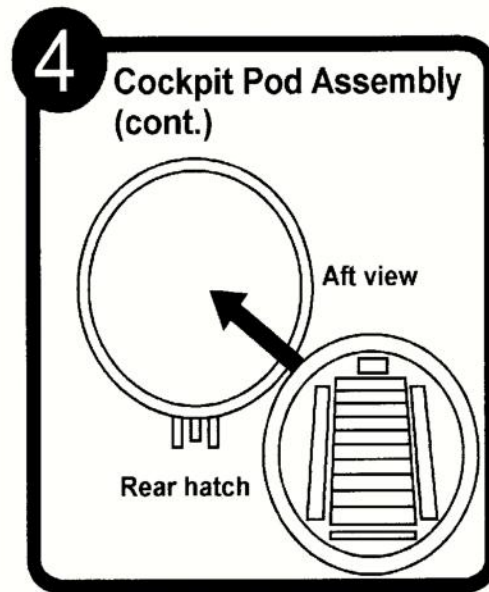
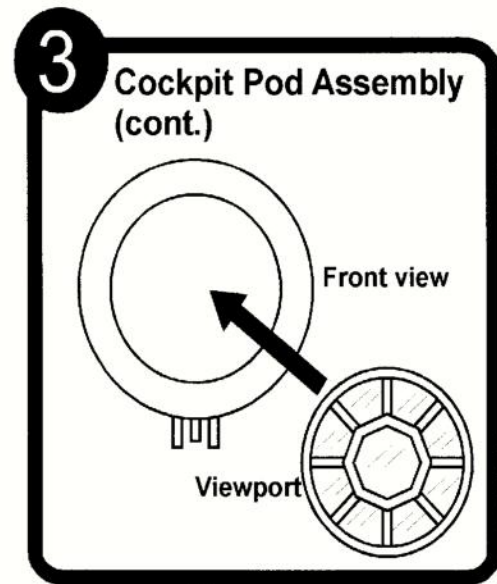
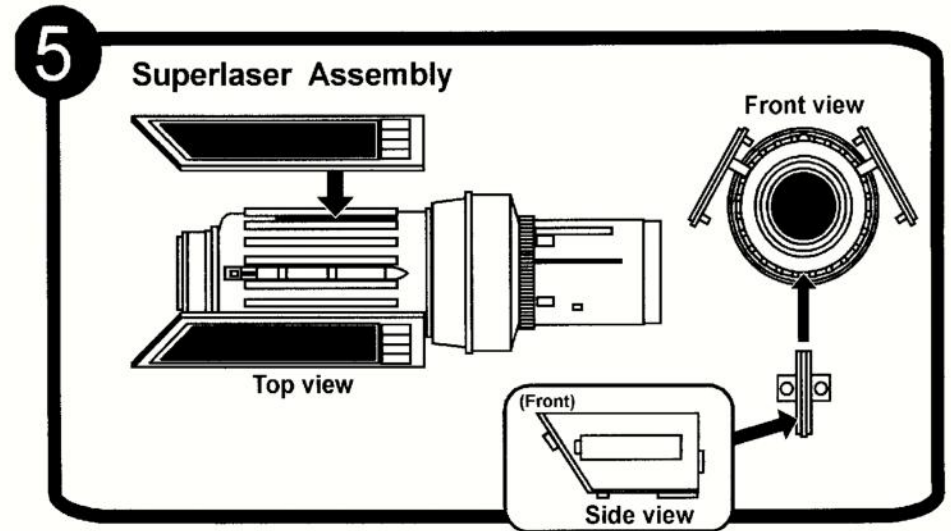
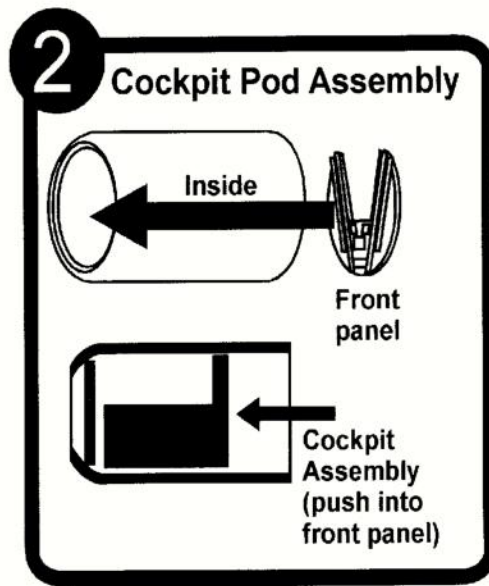
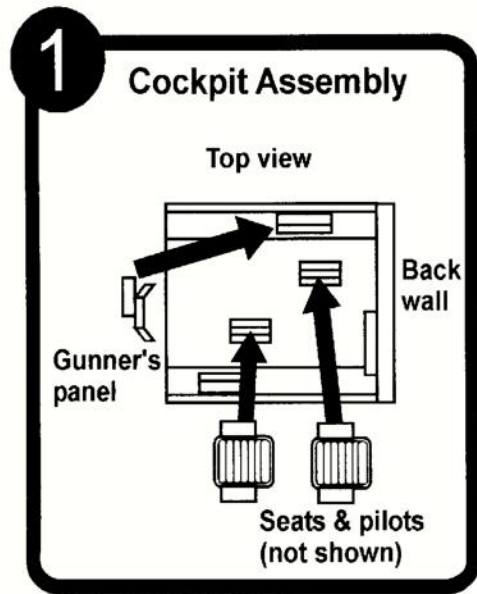

7

### Fuselage Assembly

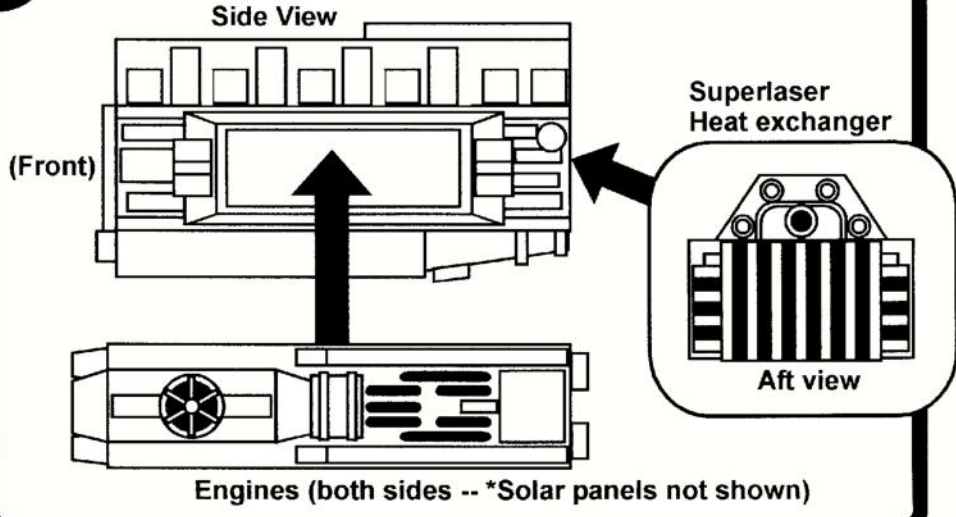

8

### Final Assembly

